

What are the functions of access layer network cabinets





Overview

Its primary functions are to provide routing, filtering, and WAN access and to determine how packets can access the core. These cabinets provide a centralized location for housing various networking equipment, such as servers, switches, routers, patch panels, and other essential devices. Simply put, a network cabinet (or network rack) is a metal enclosure used to hold and. A Layer 2 access topology provides the following unique capabilities required in the.



What are the functions of access layer network cabinets



What Is the Access Layer in Network Architecture?

Beyond simple connectivity, the Access Layer performs management and policy functions that directly affect user experience and network integrity. A common function is the local enforcement

[Contact Us](#)

A Quick Overview Of Network Cabinets And Their

Are there any drawbacks to using network cabinets? One of the best qualities of a network cabinet manufacturer is their ability to innovate. A skilled

[Contact Us](#)



Access Layer

MAC, access layer is defined as the layer that controls access to the shared wireless medium, integrating access control mechanisms to ensure that only authenticated devices can access the

[Contact Us](#)

The Ultimate Guide to Network Cabinets: Everything

It is worth noting that network cabinets are multifunctional and perform more than one important function and purpose. First, such cabinets also



Understanding Access Switches: Key Components of

Explore the role of access switches in your LAN setup. Understand their key components, functions in the access layer, and how they integrate into

[Contact Us](#)



Access Layer Functionality

Enclosed network cabinets protect equipment from dust, accidental bumps, and unauthorized access. Lockable doors add an extra layer of security,

[Contact Us](#)



ESTEL's Guide to Network Switch Cabinets and Their

A network switch cabinet organizes and protects IT equipment like switches and routers, ensuring optimal performance, security, and scalability.

[Contact Us](#)





What Is the Access Layer in Network Architecture?

The Access Layer is positioned within the standard three-tier network model, which organizes network functions into structured layers. This layered approach improves scalability,

[Contact Us](#)



What are the primary functions of a network cabinet in an IT

One of the primary functions of a network cabinet is to organize the various pieces of networking equipment. IT networks typically consist of multiple devices, including routers, switches,

[Contact Us](#)

How do network cabinets work?

Network cabinets, also known as server cabinets or network enclosures, are designed to provide a secure and organized housing for

[Contact Us](#)

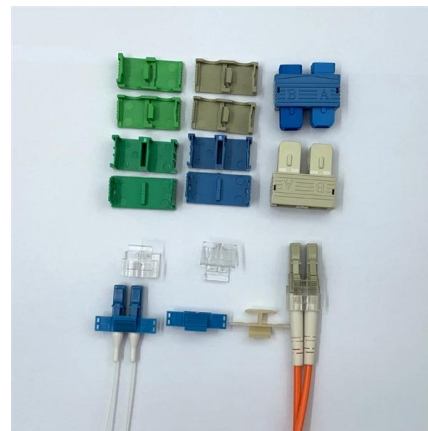

Layer Access Networking Essentials: Best Practices and

Understanding Access Layer Networking is crucial for any modern network setup, providing the groundwork for efficient and secure communication across various

[Contact Us](#)



Understanding the Role of an Access Switch in Your

Explore the crucial role of an access switch in your network. Learn how it connects end-users and devices via Ethernet, enhancing overall performance.

[Contact Us](#)

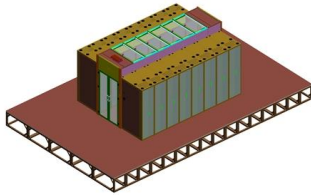

Cisco three-layer hierarchical model

This layer usually incorporates Layer 2 switches and access points that provide connectivity between workstations and servers. You can manage access control

[Contact Us](#)

Access, Distribution, and Core Layers Explained

The access layer The access layer is the first layer of the Cisco three-layer hierarchical model. This layer allows end users to access the network. It

[Contact Us](#)



The Ultimate Guide to Data Cabinets: Securing Your

It is possible for a poorly positioned cabinet to adversely affect your network in terms of security, performance, and uptime. I intend to guide you

[Contact Us](#)



Data Center Access Layer Design

The loop-free U topology design provides a Layer 2 access solution with active uplinks and redundancy via an inter-switch link between the access layer switches.

[Contact Us](#)

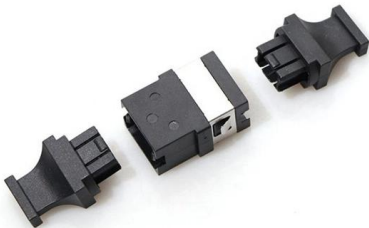

Module 6: Network Design and the Access Layer

Module Title: Network Design and Access Layer
Module Objective: Explain how communication occurs on Ethernet networks.

[Contact Us](#)

What is a Network Cabinet (Rack) and Why You Need

Discover what a network cabinet (rack) is, why it's essential and how to choose the right type (wall mount vs floor mounted closet).

[Contact Us](#)

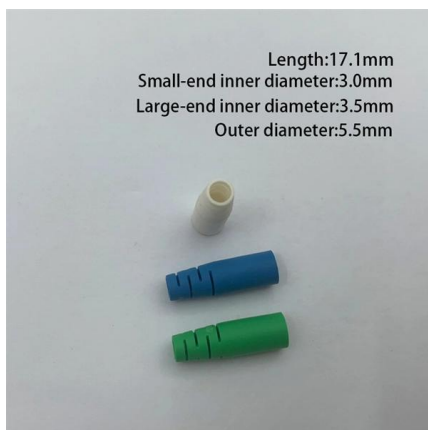
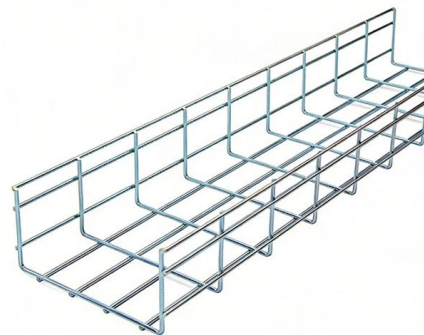

Data Center Access Layer Design

Overview of Access Layer Design Options Access layer switches are primarily deployed in Layer 2 mode in the data center. A Layer 2 access topology provides the following unique capabilities

[Contact Us](#)



A comprehensive guide to telecom racks and cabinets

Learn more about the vital role of telecom racks and cabinets play in ensuring seamless connectivity and network efficiency.

[Contact Us](#)



Contact Us

For datasheets, pricing, or custom fiber access solutions, please visit:
<https://frindel.es>