

# **Cable trays on a low-voltage circuit diagram**

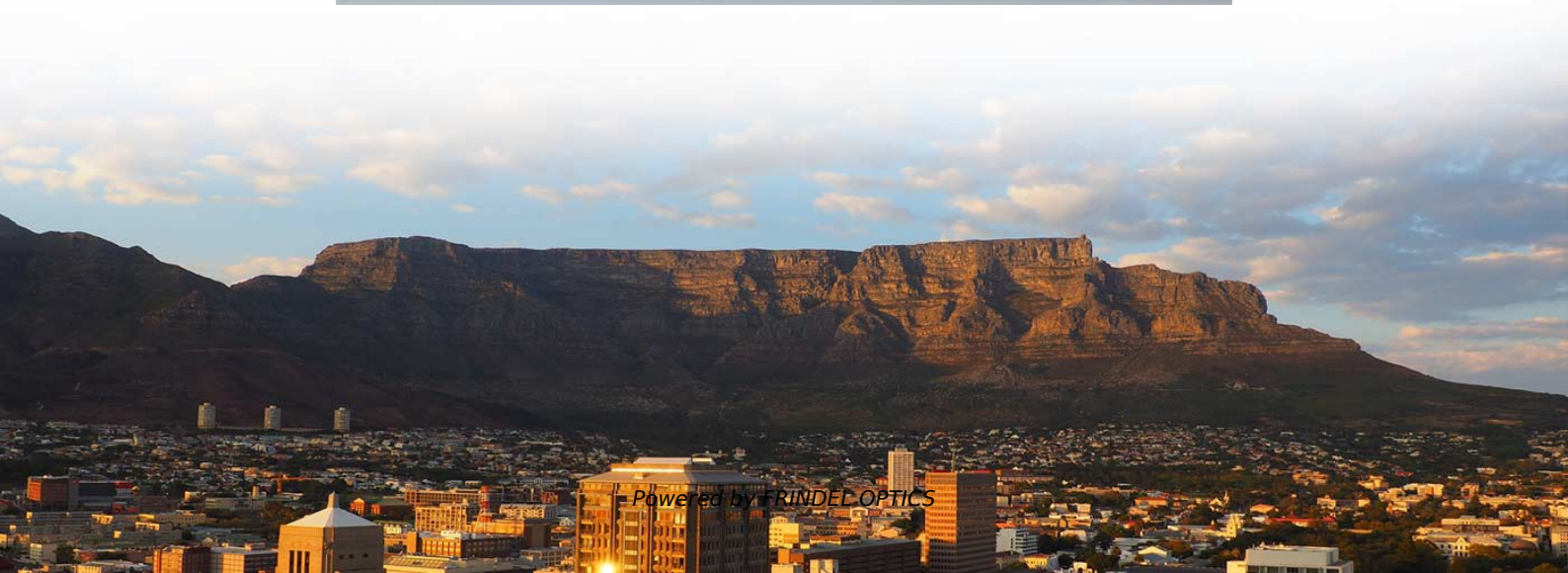



## Cable trays on a low-voltage circuit diagram

---



### Understanding Low Voltage Wiring Schematics

Explore detailed wiring diagrams for low voltage systems, covering essential components and installation tips to ensure safe and reliable electrical connections.

[Contact Us](#)

### Cable Tray Technical Guide A practical guide to product selection and

In designing supports for a cable tray system, consideration should be given to the loads associated with future cable additions and any additional loading that may be applied to the cable tray system (e.g.,

[Contact Us](#)



### Low Voltage Substation Design Guide , PDF

Clearances around cable trays, switchgear, and other equipment must follow standards like NEMA or BS, or minimum distances if local standards don't

[Contact Us](#)

### Low Voltage Substation Design Guide , PDF

Clearances around cable trays, switchgear, and other equipment must follow standards like NEMA or BS, or minimum distances if local standards don't exist. Approval from electrical

[Contact Us](#)



### Low Voltage Cable Tray

Premier Low Voltage Cable Tray Supplier in China  
Low voltage cable trays originally come from aluminum, plastic, and galvanized steel materials. All cable trays that

[Contact Us](#)



### Advanced Diploma in Electrical Design Engineering

The goal is to design safe and dependable processing facilities in a cost effective manner. The fact is that there are very few formal training programs that focus on design and engineering of Electrical

[Contact Us](#)

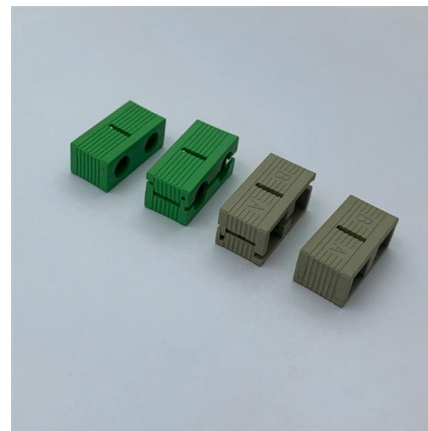

### Phase Sequence and Cable Arrangement

In the systems fed with single core cables; the cable arrangement and phase sequences should be applied as stated below in single row sequence. There are

[Contact Us](#)





## Cable tray manual

These documents: ANSI/NEMA VE-1, Metal Cable Tray Systems; NEMA VE-2, Cable Tray Installation Guidelines; and NEMA FG-1, Non Metallic Cable Tray Systems, are an excellent industry resource in

[Contact Us](#)



## Low Voltage Wiring Diagram and Installation Guide

Learn how to read and interpret low voltage wiring diagrams for electrical systems. Understand symbols, wiring connections, and safety practices for installation and troubleshooting.

[Contact Us](#)

## Instrument Location Layout and cable routing layout -

The National Electrical Code (NEC), specifically Article 392 (Cable Trays), provides strict rules on cable fill area, maximum cable sizes, and acceptable loading

[Contact Us](#)

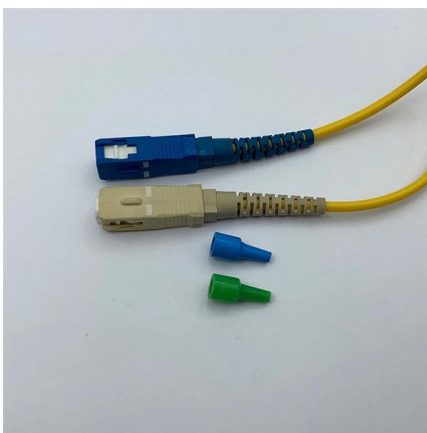

## The art of a low voltage switchgear design: The case

Also, this article will mention different forms of separation of a typical LV panel, as well as the internal and external layouts, LV panel power circuit

[Contact Us](#)

## Cable Tray Design, Layout, and Overall Wiring Planning



Learn about effective Cable Tray Design and Layout for electrical systems. Our guide covers planning, material choice, safety, and maintenance.

[Contact Us](#)

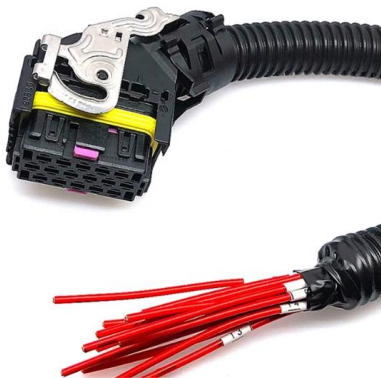

### **A Clear Path to Low Voltage Wiring**

A low voltage wiring diagram is a crucial tool in the design and installation of various electrical systems. It provides a visual representation of the connections and

[Contact Us](#)

### **Low Voltage Wiring Diagram » Wiring Diagram**

A Low Voltage Wiring Diagram is a specialized technical schematic that illustrates the electrical connections and circuit architecture for systems

[Contact Us](#)



### **Cable Tray Fill Rules (NEC 392)**

This guide covers the cable tray types and their appropriate applications, the fill rules for each configuration, ampacity derating requirements, separation of power and signal cables, and the

[Contact Us](#)



### Low Voltage Switchgear SLD Diagram

The document contains a diagram showing the electrical equipment layout for a low voltage switch gear and synchronizing panel. It includes various transformers,

[Contact Us](#)

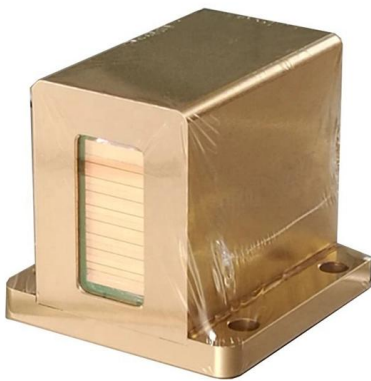

### Installation Of Cable In Cable Trays: NEC, Safety

Installation of Cable in Cable Trays ensures proper routing, cable management, NEC compliance, grounding, fire safety, and load capacity.

[Contact Us](#)

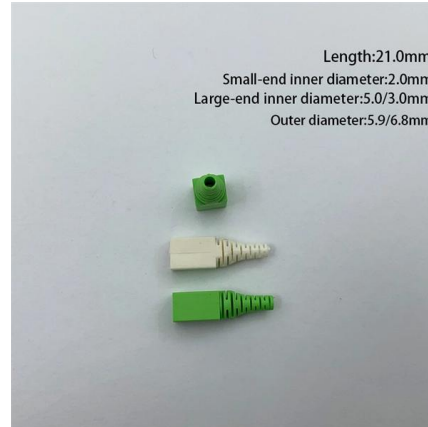

### Good practice rules for electromagnetic compatibility

Metal cable tray and prefabricated trunking enable the geometrical separation of circuits and functions and also compliance with minimum

[Contact Us](#)

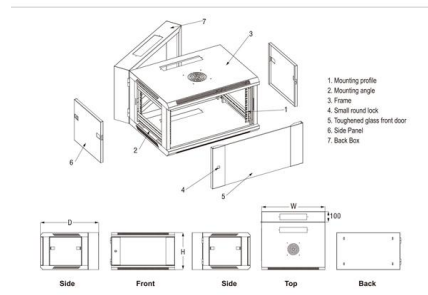

### Instrument Location Layout and cable routing layout - InstruNexus

The National Electrical Code (NEC), specifically Article 392 (Cable Trays), provides strict rules on cable fill area, maximum cable sizes, and acceptable loading depending on the type of conductor (single or

[Contact Us](#)





## Concept Cable tray drawing , PDF

This document contains a drawing list for cable tray layouts on multiple floors of a building. It includes the drawing number, size, date, and revision details for drawings of cable tray layouts on the ground,

[Contact Us](#)



## Phase Sequence and Cable Arrangement Configurations , Prysmian

In the systems fed with single core cables; the cable arrangement and phase sequences should be applied as stated below in single row sequence. There are many configurations about the systems

[Contact Us](#)

## You searched for TACT SYSTEM , Page 30 of 57 , EEP

Fire behaviour and construction safety precautions for installation of cables and conductors Although the type of cable and conductor is the determining factor in the fire behaviour of

[Contact Us](#)



## Cable Tray Technical Guide A practical guide to product selection and

A practical guide to product selection and installation This guide for engineers and installers has been developed by ABB as a practical reference regarding cable tray characteristics, installation, and

[Contact Us](#)

## Annex I



By convention, to avoid any misunderstanding and to simplify the cable tray design and installation, the bending radius for all cable trays and conduits should be at least 300 mm for Low Voltage, Sensitive

[Contact Us](#)



### GUIDE CABLE TRAYS TECHNICAL

NEMA VE 1-2017 Specifies requirements for metal cable trays and associated fittings designed for use in accordance with the rules of Canadian Electrical Code, Part I and the National Electrical Code®

[Contact Us](#)

### Low-voltage electrical installations

Fig. 2.3. Front plate of the station with a schematic diagram of the network and distribution of measuring, signaling and control elements: 1 - circuit breaker of station, 2 - voltage regulator, 3 - switch of

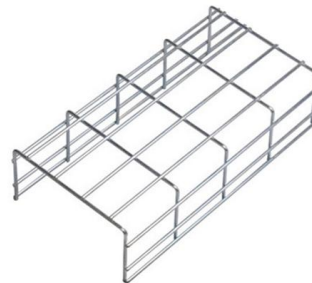

[Contact Us](#)



### Concept Cable tray drawing , PDF

This document contains a drawing list for cable tray layouts on multiple floors of a building. It includes the drawing number, size, date, and revision details for

[Contact Us](#)



## Core Principles for Electrical and Instrumentation Cable

Layered Separation: Strong current and high-voltage cables are positioned apart from low-current, low-voltage instrumentation cables. Layered separation reduces

[Contact Us](#)

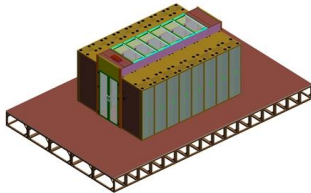

## Cable Tray Fill Rules (NEC 392)

This guide covers the cable tray types and their appropriate applications, the fill rules for each configuration, ampacity derating requirements,

[Contact Us](#)

## Guide to the Canadian Electrical Code, Part 1 - A

The ampacity of cables connecting high voltage couplers intended for use on general purpose branch circuits or feeders must not be less than the

[Contact Us](#)



## Contact Us

---

For datasheets, pricing, or custom fiber access solutions, please visit:  
<https://frindel.es>